

# HYBRIX CABINET

Installed on an Axeos unit or can be attached to the wall



## VIDEOCONFERENCING

Installation : on an Axeos unit  
or attached to the wall

Finish : white and wood

Part numbers :  
HYBRIX  
HYBRIX\_WALL



On an Axeos unit



Attached to the wall

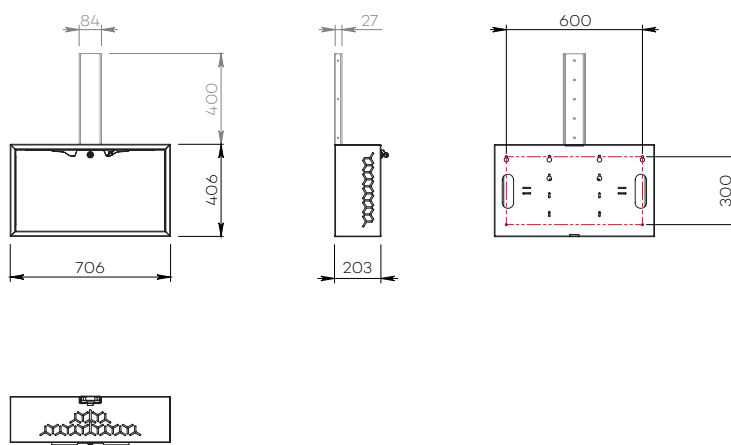

## • SPECIFICATIONS

Installation	On an Axeos unit	Attached to the wall
Part number	HYBRIX	HYBRIX_WALL
Material	White painted steel	
Useful depth	174 mm	
Door	Plate in plexiglass with wood sticker White painted steel handle	
Access	Key lock	
Secured camera installation	On the cabinet, screw fixing	
Weight	18 kg	
Axeos unit compatibility	Ekinox, Xenon-S, Osyx and Boxer	-
Included	<ul style="list-style-type: none"> <li>Internal technology holder grid</li> </ul>	<ul style="list-style-type: none"> <li>Internal technology holder grid</li> <li>Wall duct for cable management (w x d x h : 84 x 27 x 400 mm)</li> </ul>

## • OPTIONS

<b>Front door customisation</b> Plexiglass door, customised finish on request	P/N: on request
<b>Other finish</b>	P/N: on request