

STILIX DUAL SCREEN

For two screens from 40 to 70"



VIDEOCONFERENCING

Number of screen : 2 screens

Screen size : from 40 to 70"

Installation : fixed to the wall

Finish : white

Part numbers :
STILIXD4050VCPACK
STILIXD5270VCPACK



Screens simulation 46"

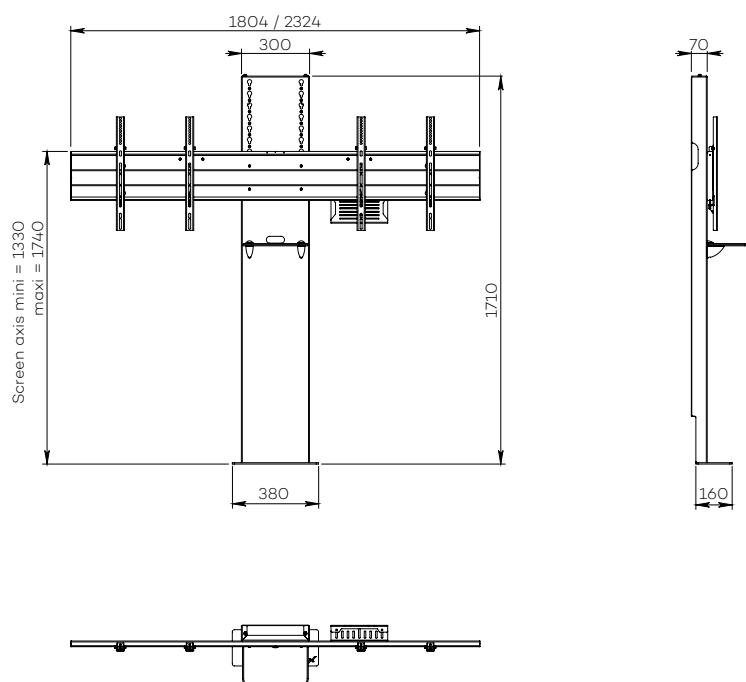
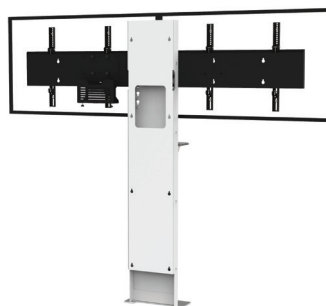

DUAL SCREEN

• SPECIFICATIONS

Screen size	For two screens from 40 to 50"	For two screens from 52 to 70"
Part numbers	STILIXD4050VCPACK	STILIXD5270VCPACK
Structure	White painted steel	
Noth for plinth	211 mm (h) x 20 mm (p)	
Base dimensions (w x d x h)	380 x 160 x 6 mm	
Column	White painted steel	
Column dimensions (w x d x h)	300 x 70 x 1704 mm	
Screen fixing	Black painted steel with fixing kit	
Screen fixing size (VESA)	From 200 x 200 mm to 800 x 400 mm	
Screen axis with adjustable height	From 1330 mm to 1740 mm	
Maximum screen weight	45 kg/screen	30 kg/screen
Stand weight	40 kg	
Accessories included (VC PACK)	<ul style="list-style-type: none">• Camera shelf in plexiglass (SMCP/CPS) Dimensions (w x d) : 290 mm x 200 mm• 1U codec or player holder (SCUV12_1U) Depth from 30 mm to 67 mm	

• OPTIONS

Black finish	P/N: /BLACK
Universal camera holder Above the screen	P/N: SCUV3
SCUV3 option Adaptor to fix the SCUV3 between two screens	P/N: SCUV3_2
Other finish	P/N: upon request